



LET BY  
**Aspen**  
estate agents  
www.aspenestateagents.co.uk  
01784 433696

25 St Judes Road, Egham, TW20 0BY

£2,600 PCM



## 25 St Judes Road, Egham, TW20 0BY

A three bedroom student house situated within a few minutes' walk to the university. There are three double bedrooms and two shower rooms, with a kitchen/diner on the lower ground floor, a downstairs cloakroom and a snug on the ground floor. There is also a good size garden. EPC Rating: C.



Floor Plan

**Lower Ground Floor**  
Approx. 31.7 sq. metres (341.6 sq. feet)

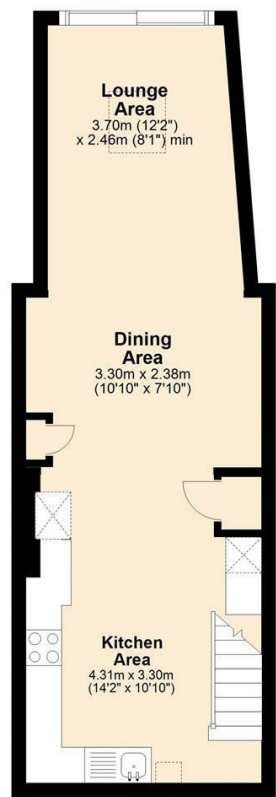

**Ground Floor**  
Approx. 22.7 sq. metres (244.2 sq. feet)

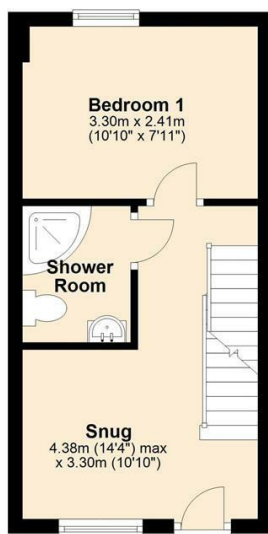

**First Floor**  
Approx. 22.0 sq. metres (236.8 sq. feet)



Features

10 St Judes Road, Englefield Green, Surrey TW20 0BY  
Tel 01784 433696  
sales@aspenestateagents.co.uk

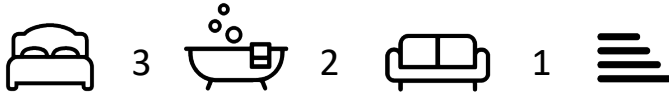

Tenure - Council Tax Band - D

